

# Hotwire Thermostat Instructions

Model Number: HWGL2 Dual WiFi Thermostat

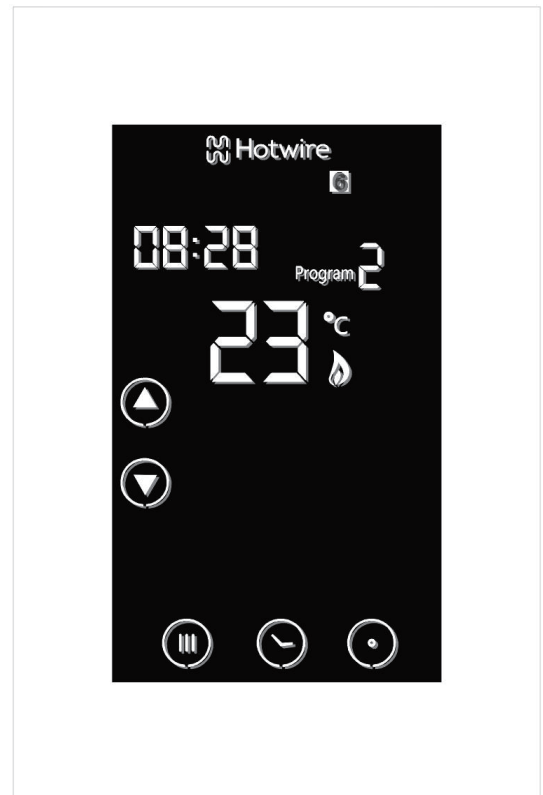



# Hotwire Thermostat

## Technical Information

To enter into the setting menu please follow the steps below:

Step 1. Turn the thermostat off by pressing 

Step 2. Press  you will then see menu 1.(Press and hold  for about 5 seconds, you will see menu 12)

Step 3. Use the increase and decrease arrows to adjust the sensor selection which is Menu 1 (Air sensing; Air and Floor, or Floor only)

Step 4. Press  to move to the next Menu and once you have all the menu options set, press  to accept and store.

Menu #	Feature	Explanation	Adjustment (Press up & down buttons to adjust)
1	Mode/Sensor Selection	This thermostat is a combination model which allows you to choose 3 different modes. A mode = Air Sensing Only (Has built in sensor) AF mode = Air & Floor sensing (Floor probe must be installed) F mode = Floor Sensing (Floor probe must be installed)	A / AF / F
2	Switching differential	The number of degrees difference before switching. The default is 1°C which means the thermostat will switch the heating on 0.5°C below the set temperature and will turn it off 0.5°C above the set temperature. With a 2°C differential the heating will switch on 1°C below the set temperature and will switch off 1°C above the set temperature.	1 Deg C, 2 Deg C....10 Deg C ( 1 Deg C by default)
3	Air Temp Calibration	This is to recalibrate the air temp if required	-1 Deg C = decrease 1 °C , 1 Deg C = increase 1 Deg C
4	Floor Temp Calibration	This is to recalibrate the floor temperature if required	-1 Deg C = decrease 1 °C , 1 Deg C = increase 1 Deg C
5	Temperature Readout (AF mode only)	This gives you the option to show the Air Temp, Floor Temp or to show both Air & Floor at intervals	A = Show Air Temperature F = Show Floor Temperature A-F = Show Floor and Air Temperature in 5 sec intervals
6	Maximum Floor Temp ( AF Mode only)	This is to protect the floor surface	20 Deg C - 40 Deg C (40 Deg C by default)
7	Temperature Format	This allows the temperature to be set to show Deg Celsius or Deg Fahrenheit	Deg C / Deg F
8	Frost Protection	This is to avoid your room temp going below 5 DegC	On = activated, Off = deactivated
9	5+2 / 7 Day mode	This allows you to programme either 5 days at once, then the 2 days of the weekend separately, or a full 7 days at the same time or 7 days separately.	01 = 5 + 2 Day Programming 02 = 7 Day Programming
10	Auto/Manual mode selection	This allows you to choose Auto / Manual mode	00 = Auto mode 01 = Manual mode
11	Software version	This is for review only	V1.0
12	Minimum temperature limit	This gives you the option to change the minimum set temperature	5 °C ~ 20 °C (5 °C by default)
13	Maximum temperature limit	This gives you the option to change the maximum set temperature	40 °C ~ 90 °C (40 °C by default)
14	Sensor type selection	This allows you to match your thermostat to different sensor	10 = NTC10K (by default), 100 = NTC100K, 3 = NTC3K
15	Backlit brightness	This allows you to adjust the brightness of the back light	10% ~ 100% 100 =
16	Reset	This allows you to reset your thermostat to factory default	Press and hold down button until you see RE on screen
17	Direction of installation	This allows you to choose to install your thermostat vertically or horizontally	L = Vertical H = horizontal

# Hotwire Thermostat Instructions



The thermostat is a Dual Control model. You can use it to program both your Hotwire Floor Heating and Hotwire Heated Towel Rail.

This manual outlines how to program the unit. If you have any difficulties we have a step by step video on our website at, [www.hotwireheating.com.au](http://www.hotwireheating.com.au) (Australia) [www.theheatingcompany.co.nz](http://www.theheatingcompany.co.nz) (New Zealand)

## LCD symbols

### Icon Legend

	The buttons are locked
	Heating is turned on
	Frost protection activated
	Manual mode
	Temporary temperature override
Er	The floor sensor is not being read by the thermostat
<b>1 2 ... 1 2 ... 7</b>	Day of the week
	Increase button (  for horizontal mode)
	Decrease button (  for horizontal mode)
	Confirmation button (  for horizontal mode)
	Power button
	Time and Day button
	Programme button / Menu button (short-press) Auto mode / Manual mode selection button (long-press)

## Alternating Heating Zones

In order to alternate between the devices or heating zones being controlled press and hold " " The LCD will display temperature (e.g. 22 °C) or ON/OFF. Temperature will be your under floor heating. ON/OFF will be your heated towel rail.

## Setting the clock and day of the week

This thermostat is fitted with a real time clock. It is essential that the clock time and day are set accurately if you require your programmed events to start on time. To set follow the steps below:

- Touch the " " button and the time will start flashing. Use the increase and decrease buttons to set the time. By holding these buttons down the time will change faster.
- Press " " to move to the Day setting and use the increase and decrease buttons to get to the correct day.
- Press " " to store and exit.

## Setting the Programme Schedules

This thermostat has the ability to programme each individual day of the week separately, or programme 7 days of the week at once. You can also programme weekdays (5 days) to one schedule and then weekends (2 days) to a different schedule. See the Menu information for details on how to set this up.(refer to Menu 9) *See page 4 of this manual.*

## Programming your Thermostat.

This will help you program your thermostat to come on and off automatically. If you want to simply turn it on and off when required skip this section. When programming Zone 2 for your Heated Towel Rail it will not be necessary to set the temperature in the below steps. You simply set the time only and then select "On" for options 1 and 3, and "Off" for options 2 and 4.

- Press " " and the day display will start flashing. Using the Increase or Decrease button to select the day you wish to programme.(If your thermostat is set to 5+2 day programmable mode, the programming will skip to step 3)
  - To select every day to be the same simply press and hold the Decrease button.
  - Press " " and Program 1 is displayed. This is the first programme function of the day.
  - The time is now flashing. Select the time you want the heating to come on in the morning " "
  - The temperature is now flashing. Set the temperature that you want the floor to heat. Then press " "
  - The LCD screen will show Program 2 and the time will be flashing. This is the time that the thermostat will switch off in the morning.
  - Use Increase and Decrease buttons to adjust the time you wish the heating to switch off in the morning on the selected day or days.
  - Press " " and the temperature will start flashing. This can be used to maintain a minimum temperature. In most cases this is not required and the temperature should be set to 5.
  - Press " " and the Program 3 will display. The time is also flashing. Set the time at which you want the heating to come on in the afternoon or evening. **NOTE:** If you do not wish the heating to come in the afternoon, simply set the "off" time for only a couple of minutes after the "on" time.
  - Press " " and set the temperature required in the afternoon.
  - Press " " and the LCD screen will show Program 4. This is the time that the thermostat will switch off in the afternoon / evening. Press " " and set the temperature. As per above we recommend 5. Then Press " "
- (\*). Hint: If you use the default programming of 5 week days plus 2 weekend days you will now need to repeat the above steps for the weekend. You may use " " to delete time periods for the weekend schedule.

## Default Programming is as follows.

Programme	Start Time	Setpoint	Explanation
01	WAKE 06:00	24 °C	This is the time the heating will come on in the morning.
02	LEAVE 08:30	16 °C	This is the time the heating will switch off in the morning. It can also be used to set a minimum temperature for the day.
03	RETURN 18:30	24 °C	This is the time the heating will come on in the afternoon.
04	SLEEP 22:00	16 °C	This is the time the heating will switch off in the afternoon / evening. If you do not require the heating in the afternoon / evening, simply set this time to a couple of minutes after the "on" time.

# Hotwire Thermostat Instructions

## Installation and Wiring

Carefully separate the front half of the thermostat from the back plate by unscrewing the small screw at the bottom of the thermostat. Carefully unplug the ribbon connector which is plugged into the front half of the thermostat. Place the thermostat front half somewhere safe. Terminate the thermostat as shown in the diagrams below.

Screw the thermostat back plate onto the flush box

Re-connect the thermostat ribbon cable and clip the two halves together.

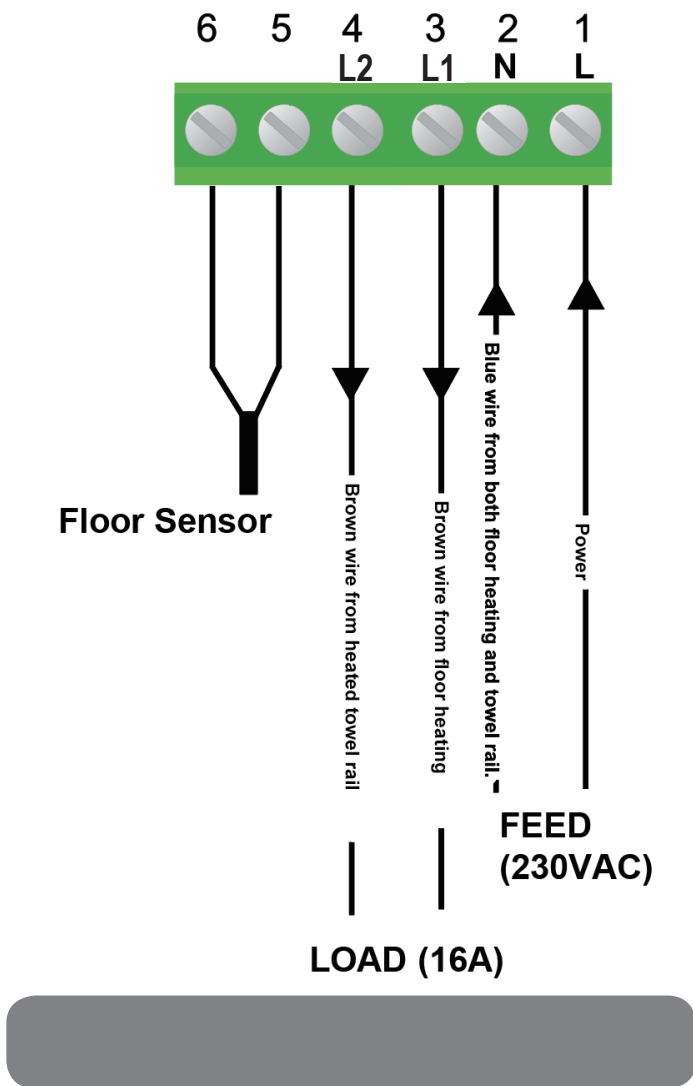

This product should be installed by a qualified electrician.

### Change between Manual and Auto Mode

To change between Auto and Manual mode press and hold . In manual mode, the thermostat maintains a constant set temperature manually set by the user. Simply adjust the temperature using the arrows. In Auto mode, the thermostat executes the preprogrammed schedules.

### Lock the Keypad

To lock the keypad, press and hold the power button for 5 seconds, you will see a key symbol . To unlock, repeat the steps above and the key symbol will disappear.

### Reset to Factory Setting

To conduct a master reset to factory settings, press the power button to turn the thermostat off. Press and hold  for 5 seconds. Move to menu 16 then hold the Decrease button for 5 seconds.

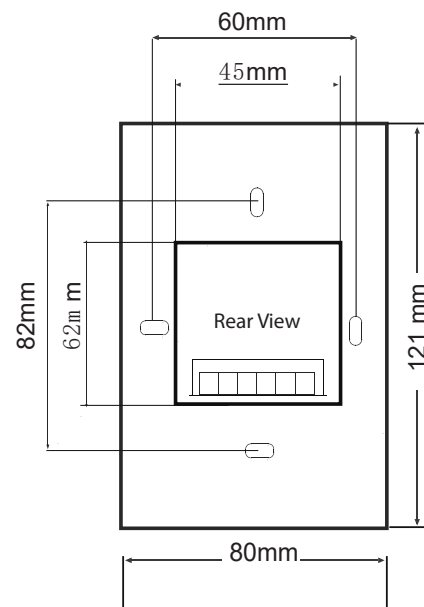

# Hotwire Thermostat Instructions



hi thermostat

## Connecting to WiFi (iPhone)

### Get ready for connection

Go to the App Store, download “Hi Thermostat” app and install it. Then create an account with your email address and sign in. Ensure you are connected to your WiFi network, keep your phone, your thermostat, and your WiFi router as close as possible.

Step 1. On your thermostat, press the power button to turn your thermostat off.

Step 2. Press and hold the power button for 5 seconds until you see REF on screen. Wait for a few seconds until the wifi symbol is flashing.

### Step 1

- (1). Touch “+” on the top right corner of your phone to add a new device;
- (2). Enter your WiFi details. Please ensure you have selected the correct WiFi network and the password you enter is correct. Then press “Confirm”.

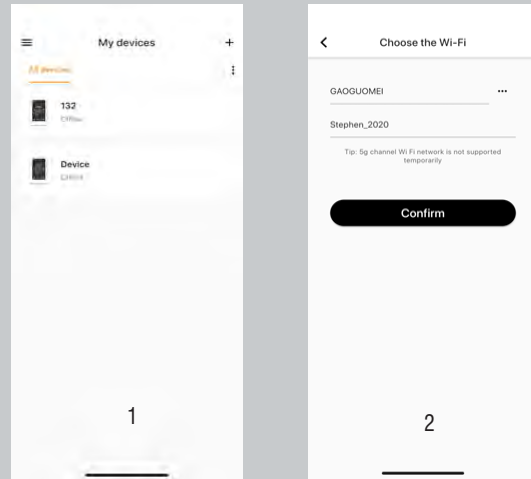

### Step 2

- (1). Press “Connect”.
- (2). Press “Join” as your phone wants to join device’s WiFi hotspot named XPG-GAgent-xxxx;
- (3). Press “Join” as your phone needs to go back to your original WiFi network. The connection process is automatically completed. Now your thermostat is accessible via the app.

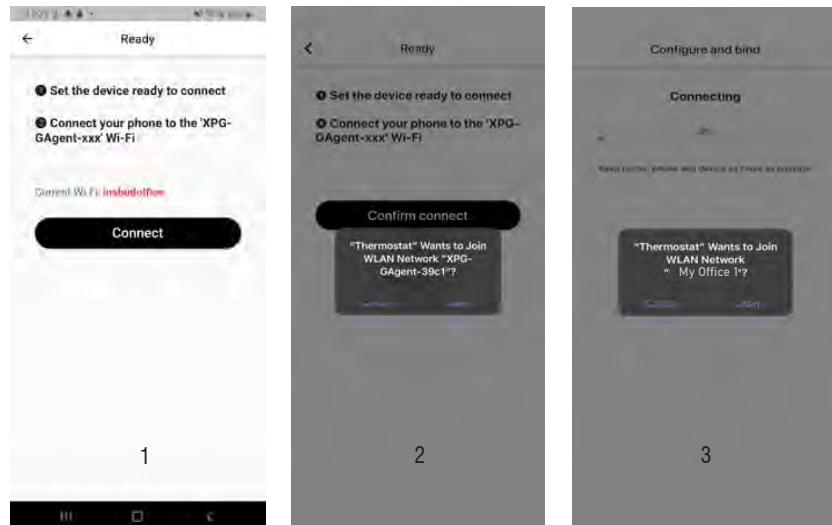

### Troubleshooting

Some phones might not be able to join device’s WiFi hotspot automatically. In this case, please do it manually. Follow the steps below:

- (1). In Step 2, before pressing “Connect”, please go to your phone’s Settings - WLAN.
  - (2). Connect your phone to device’s WiFi hotspot named XPG-GAgent-xxxx;
- Once connected to XPG-GAgent-xxxx, return back to the thermostat app and follow Step 2 above.

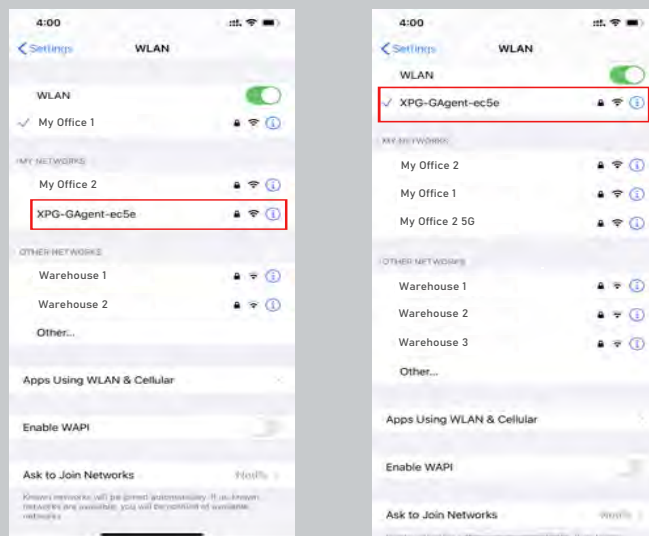

# Hotwire Thermostat Instructions



## Connecting to WiFi (Android)

Scan to download app

### Get ready for connection

Go to Google Play, download “Temp Control” app and install it. Then create an account with your email address and sign in. Ensure you are connected to your WiFi network, keep your phone, your thermostat, and your WiFi router as close as possible.

Step 1. On your thermostat, press the power button to turn your thermostat off.

Step 2. Press and hold the power button for 5 seconds until you see REF on screen. Wait for a few seconds until the wifi symbol is flashing.

### Step 1

- (1). Touch “+” on the top right corner of your phone to add a new device;
- (2). Enter your WiFi details. Please ensure you have selected the correct WiFi network and the password you enter is correct. Then press “Confirm”.

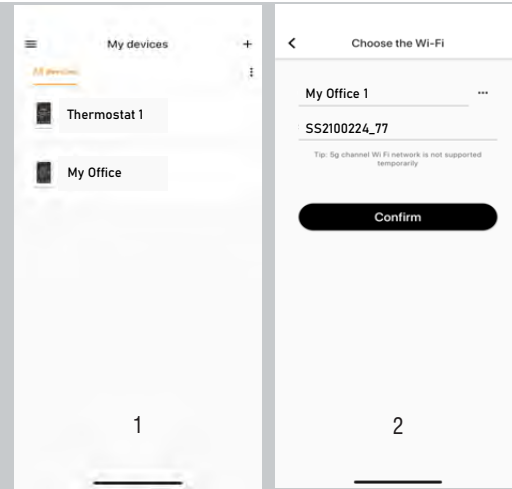

### Step 2

- (1). Press "Connect".
- (2). Press "Go to connect".

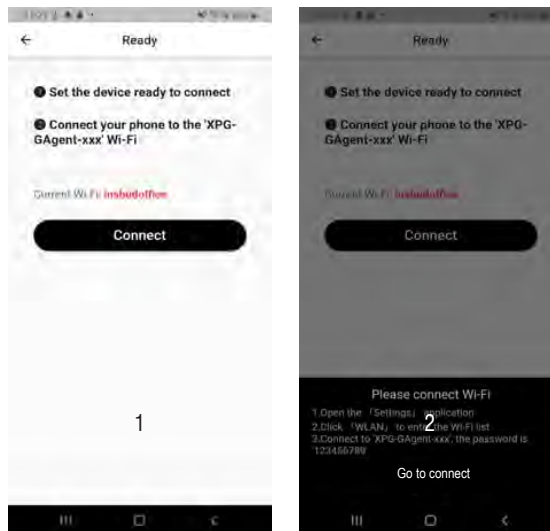

### Step 3

- (1). Now your phone automatically goes to WLAN settings page.
- (2). Connect your phone to device's WiFi hotspot named XPG-GAgent-xxxx;
- (3). Once connected to XPG-GAgent-xxxx, return back to the thermostat App and the connection process will automatically be completed. Now your thermostat is accessible via the app.

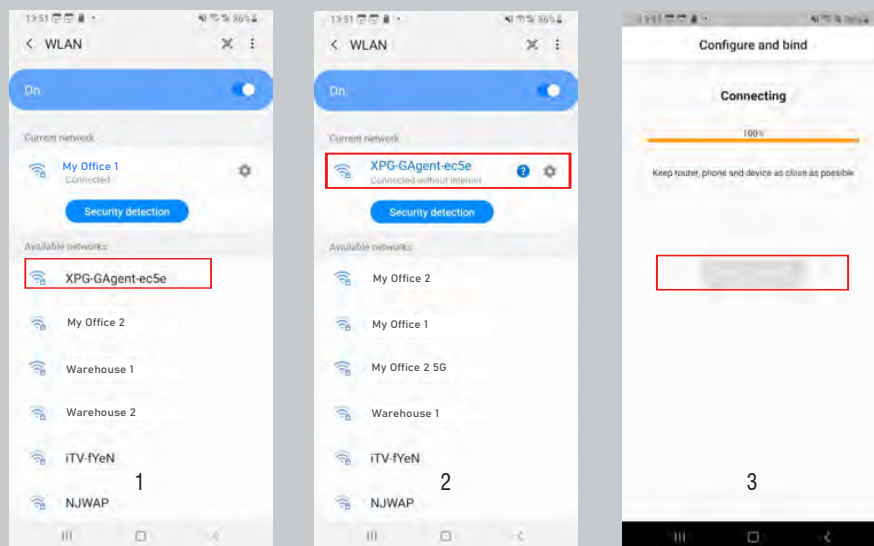

# Hotwire Thermostat Instructions

## Sharing Your WiFi Thermostat



### Step 1

(1). Touch the edit/pencil button on the top right corner of the app.



### Step 2

(1). Click "Sharing "device".

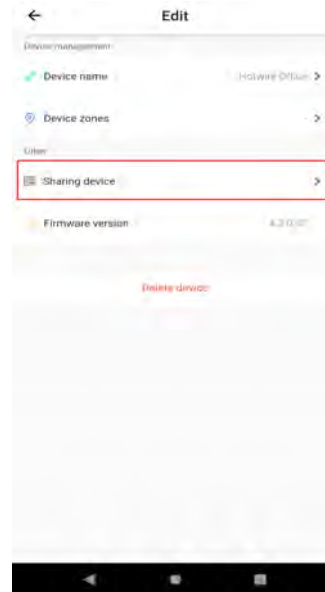

### Step 3

(1). Scan the QR code on the phone of the person you want to share the device with.



Copyright 2024 Hotwire IP Pty Ltd. All rights reserved. This article may not be reproduced, distributed, or transmitted in any form or by any means, including photocopying, recording, or other electronic or mechanical methods, without the prior written permission of the copyright holder.



**AUSTRALIA**  
Hotwire Heating  
[WWW.HOTWIREHEATING.COM.AU](http://WWW.HOTWIREHEATING.COM.AU)

**NEW ZEALAND**  
The Heating Company  
[www.theheatingcompany.co.nz/](http://www.theheatingcompany.co.nz/)